

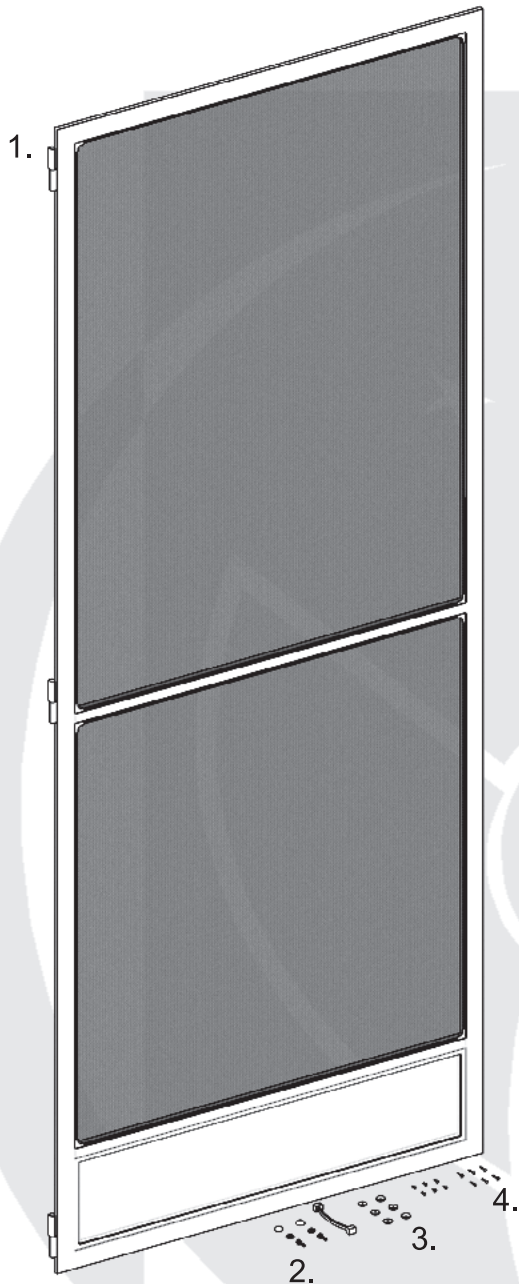

Instrukcja montażu

Moskitiera ramowa drzwiowa.

Dostawa powinna zawierać:



1. Moskitiera.
2. Rączka.
3. Magnesy i blaszki.
4. Śruby.

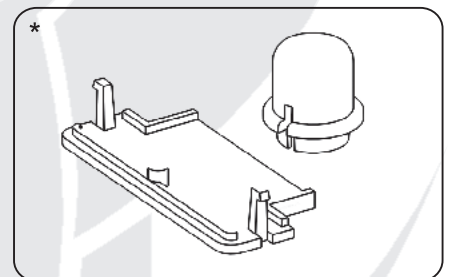
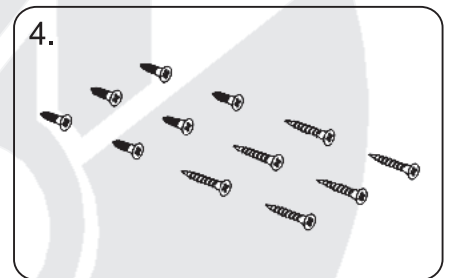
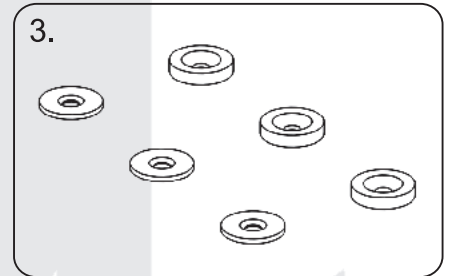
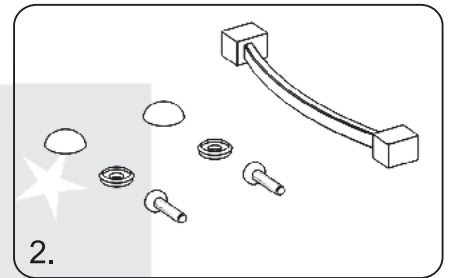

* zaślepki – dot. montażu samozamykacza

Pomiar okna.

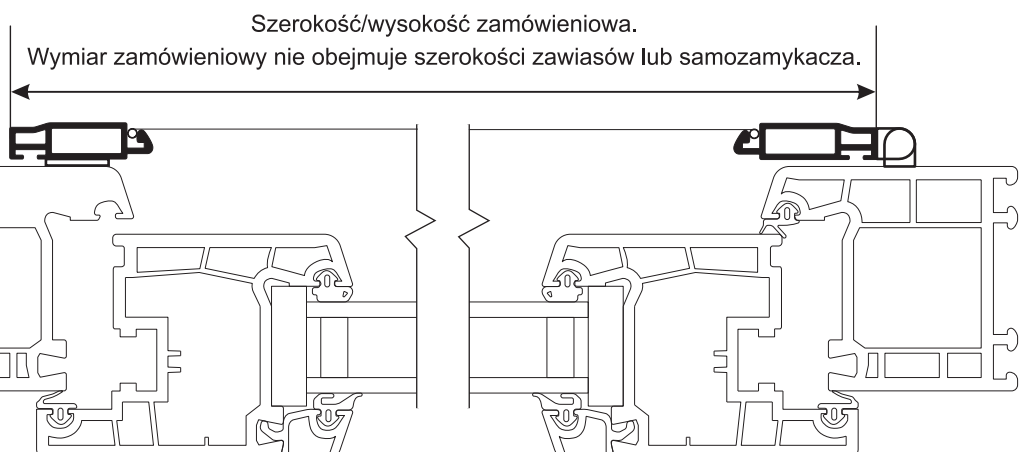

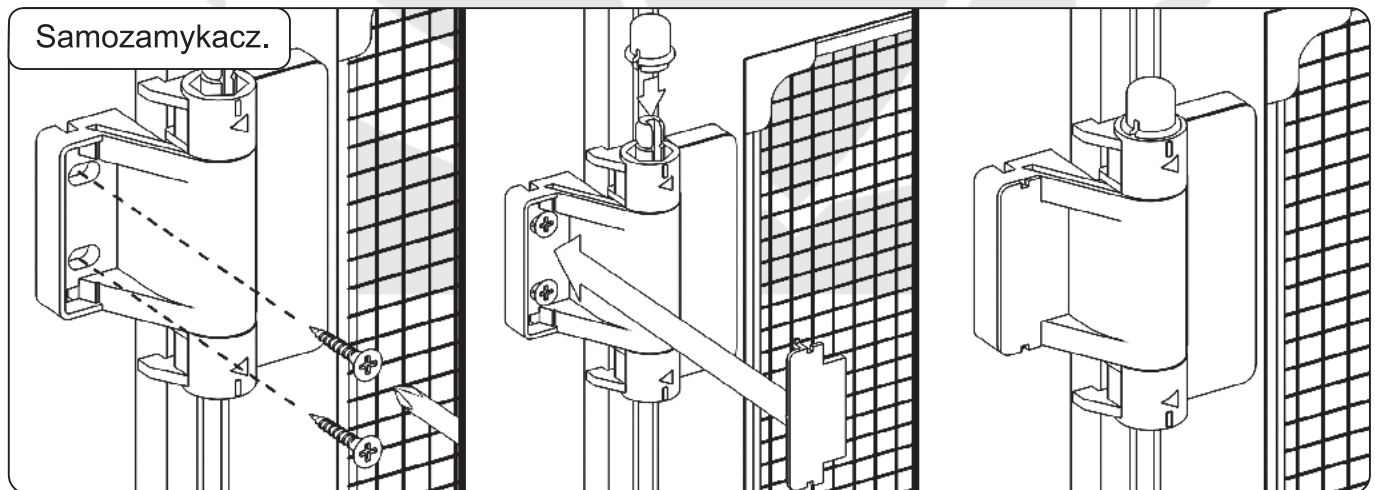
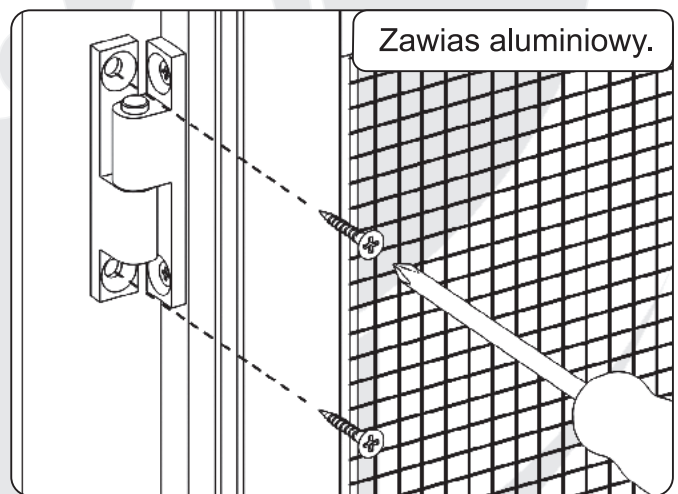
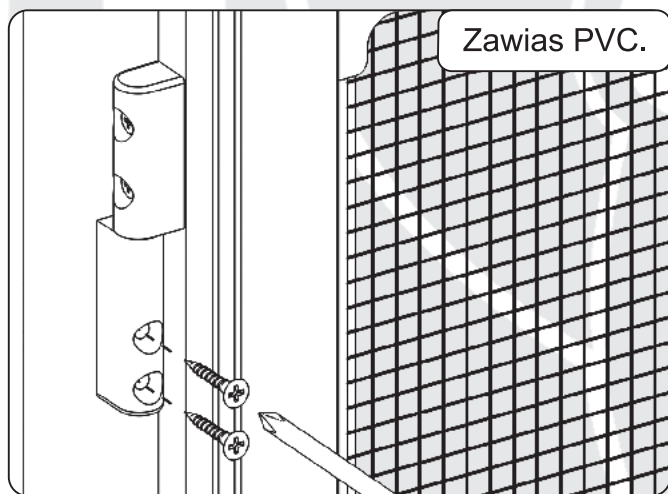
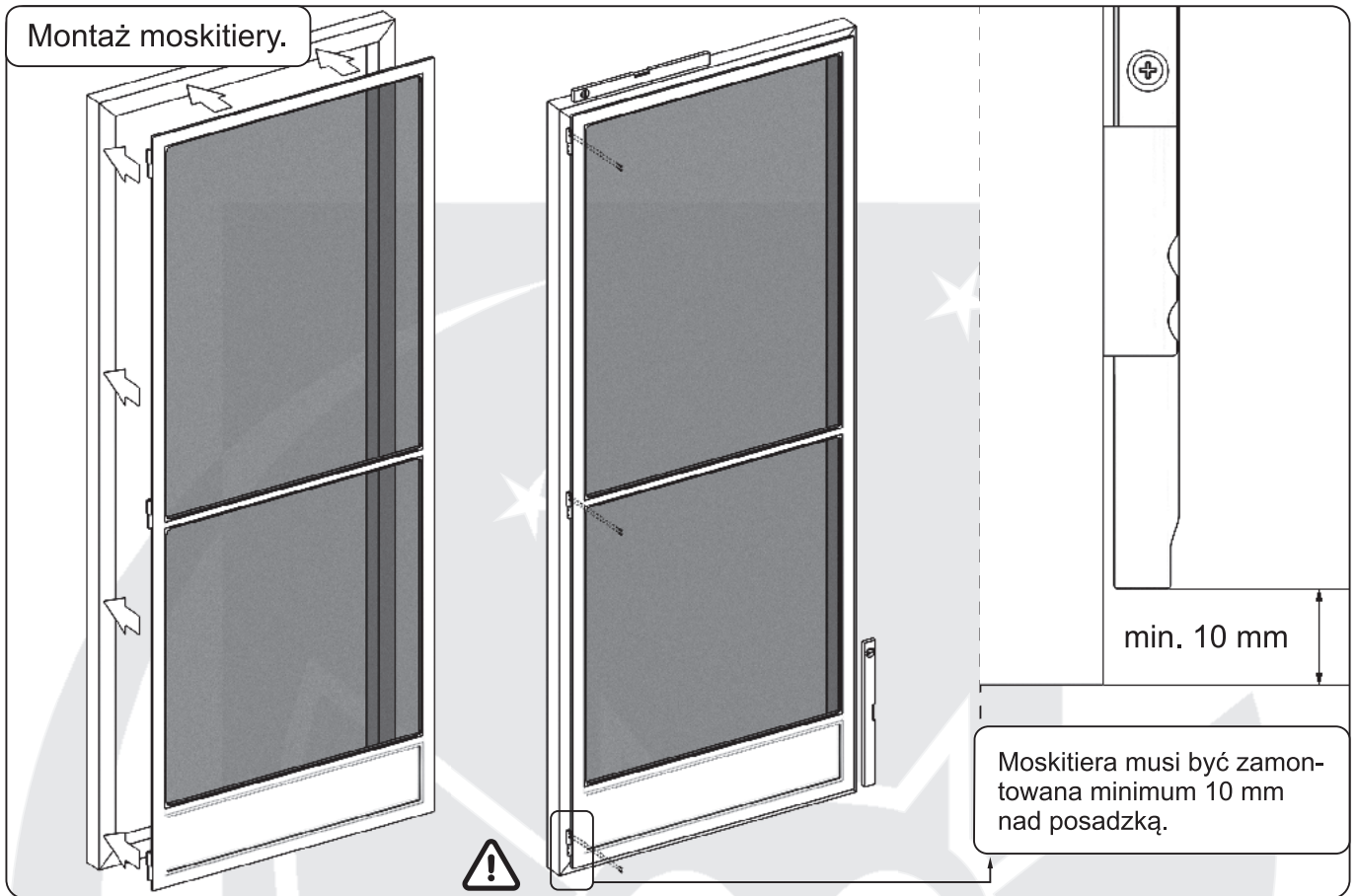

Montaż magnesów i rączki.

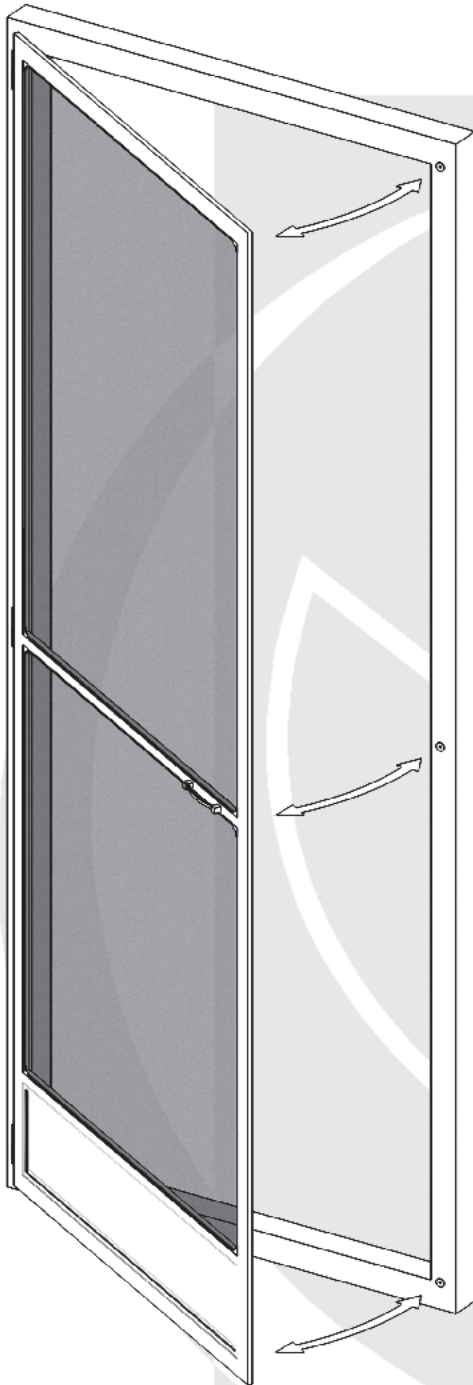

Przykręć magnesy do ramy.

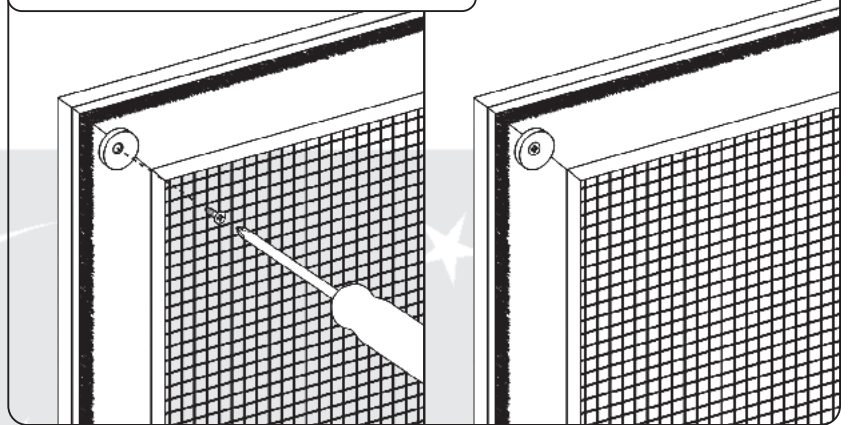

Nałóż blaszki na śrubki i umieść je na magnesach.

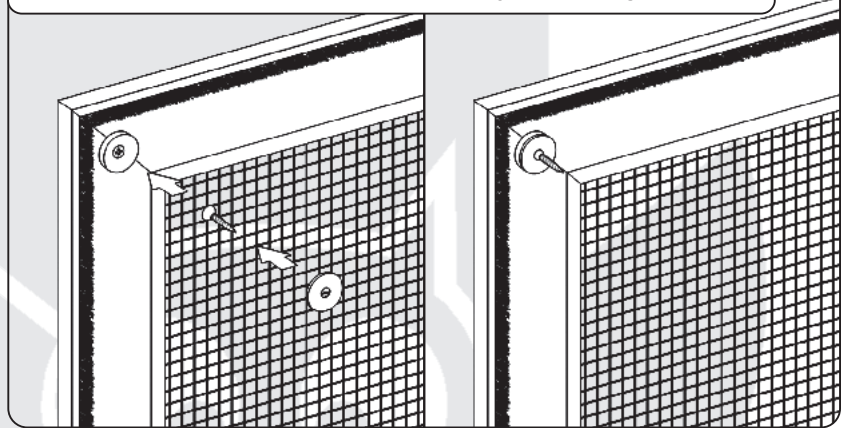

Przymknij aby dotknąć ramy.

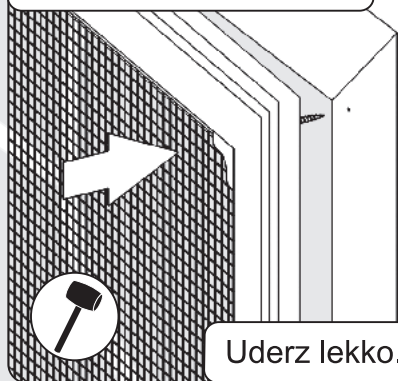

Uderz lekko.

Przykręć blaszki w miejscu powstałych zagłębień.

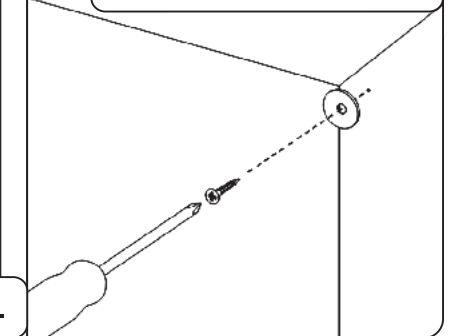

Montaż rączki.

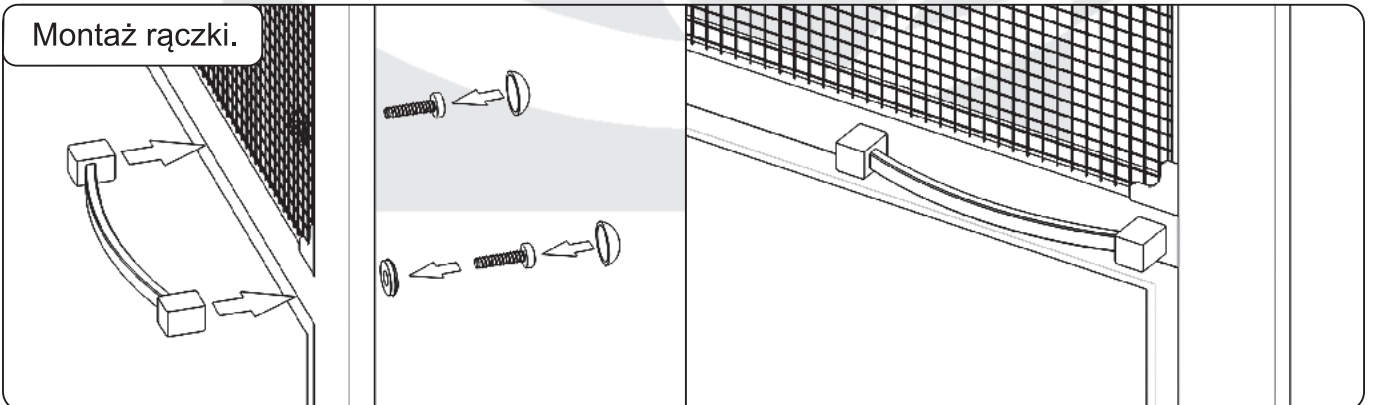



P.P.H.U FART PRODUKT Lewicki Wiesław

ul. Towarowa 3, 87-100 Toruń

tel. 56 623 55 77, 56 658 93 85

fax 56 623 55 77, 56 658 93 85 wew. 33

e-mail: biuro@fartprodukt.pl

www.fartprodukt.pl